

For FAQs and more information, please contact:

support@out-input.com

www.out-input.com

PAP 22

Raccolta carta

ThinkTech Innovation Inc  
4888 Dexter Dr #100, Plano, TX 75093, USA

EU REP VAT SPEED SL  
CALLE ANTONIO SALVADOR N99-1, 28026 MADRID, SPAIN

UK REP EVATOST CONSULTING LTD  
OFFICE 101 32 THREADNEEDLE STREET, LONDON, UNITED KINGDOM, EC2R 8AY

Version 1.0

outinput

## User Manual Smart Bird Feeder

support@out-input.com

www.out-input.com

MODEL: PF710

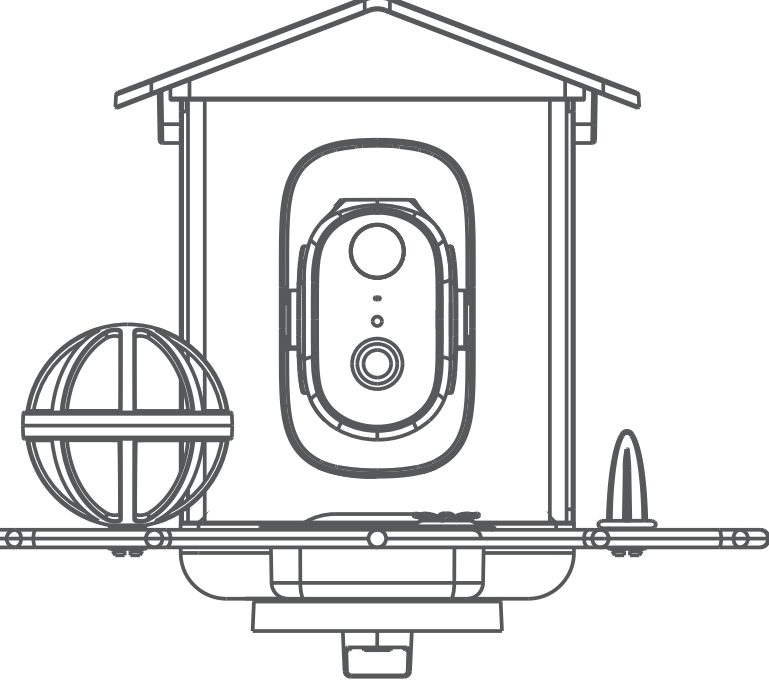

### contents

Attention	01-02
What's in the Box	03
Product Diagram	04
Setup Instruction	05-08
Outdoors Installation	09-10
Adding Bird Seed	11
App Function	12
FAQs	13
Specifications	14
FCC	15
CE	16

### Attention

All the safety and operating instructions should be read before use and should be followed to avoid injury, fire, electric shock, property loss, and other risks.

- This product has an internal battery, keep the device away from water, fire, humidity or hot environments.
- This product contains batteries that are non-replaceable.
- Do not use damaged charger or USB cable to charge the device.
- Do not use any other chargers than those recommended.
- Do not use the device where wireless devices are not allowed.
- Adapter shall be installed near the equipment and shall be easily accessible.
- Use only power supplies which are provided by manufacturer and in the original packing of this product. If you have any questions, please don't hesitate to contact us.
- Do not modify or repair the internal battery.
- Do not disassemble, repair or modify the product.
- Do not use the product if the casing has been broken. Danger of electric shock.
- Never touch the product with wet hands.
- Do not expose to heavy rain or any type of moisture.
- Do not place near automatically controlled devices such as fire alarms. Radio waves emitted from this product may cause such devices to malfunction resulting in an accident.
- Observe restrictions on using wireless products in fuel depots, chemical plants or when blasting operations are in progress.
- Do not use liquid to clean the product. Only use a dry cloth.
- Never put metal objects inside the product. If a metal object enters the product turn off the circuit breaker and contact an authorised electrician.
- This product is intended to be used when providing medical care. Consult the manufacturer of any personal medical devices, such as pacemakers or hearing aids to determine if they are adequately shielded from external RF (radio frequency) energy.

- Do not use this product in health care facilities. Hospitals or health care facilities may be using equipment that could be sensitive to external RF energy.
- Under abusive conditions, liquid may be ejected from the battery, avoid contact. If contact accidentally occurs, flush with water. If liquid contacts eyes, additionally seek medical help. Liquid ejected from the battery may cause irritation or burns.
- Do not use an appliance that is damaged or modified. Damaged or modified batteries may exhibit unpredictable behavior resulting in fire, explosion or risk of injury.
- Do not use this product near water for example near a bath tub, wash bowl, kitchen sink or laundry tub, in a wet basement or near a swimming pool.
- Do not expose a battery pack or appliance to fire or excessive temperature. Exposure to fire or temperature above 130°C may cause explosion.
- The product should be kept free from excessive smoke, dust or high temperature and vibration.
- This product should not be exposed to direct sunlight.
- Do not place heavy objects on top of the product.
- When you leave the product unused for a long time unplug the product from the power outlet.
- Product should be kept away from heat sources such as radiators, cookers etc. It should not be placed in rooms where the temperature is less than 0 degrees or greater than 40 degrees. Damp basements should also be avoided.
- This product may interfere with other electronic products such as TV, radios, personal computers, phones or other wireless devices.
- Operating Temperature: -10°C ~ 50°C (-14°F ~ 122°F)
- Operating Humidity: 10%~90%RH, Non-condensing

Please read and follow the above safety information when operating the device. We cannot guarantee that no accidents or damage will occur due to improper use of the device. Please use this product with care and operate at your own risk.

### What's in the Box

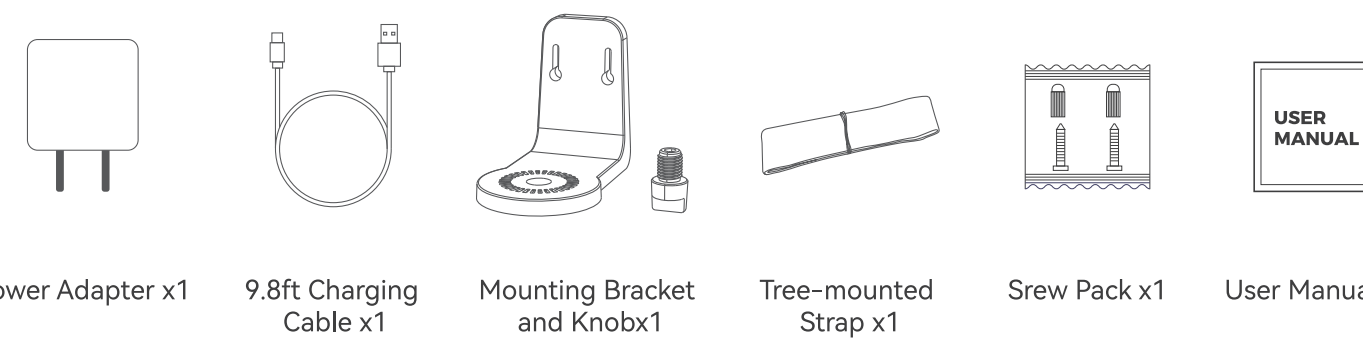
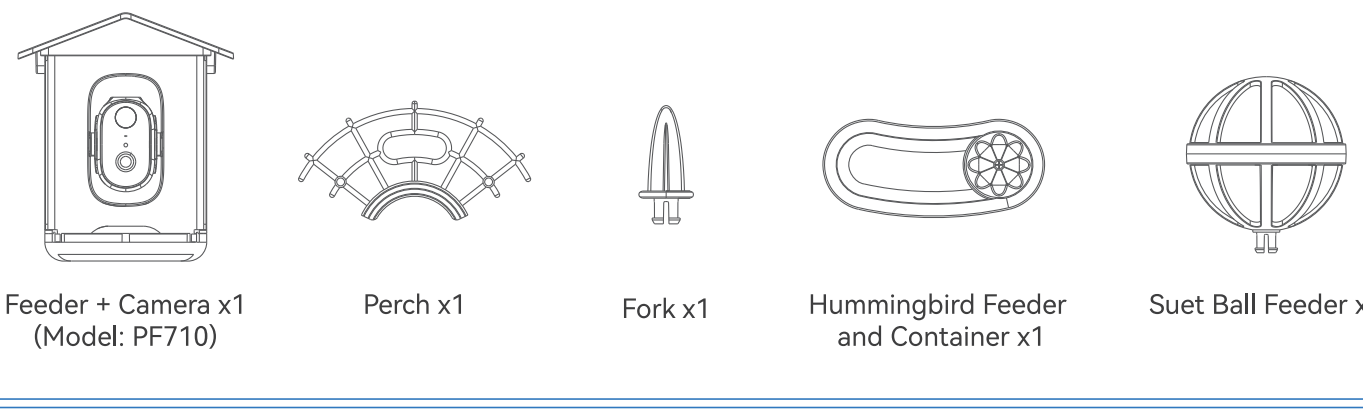

### Product Diagram

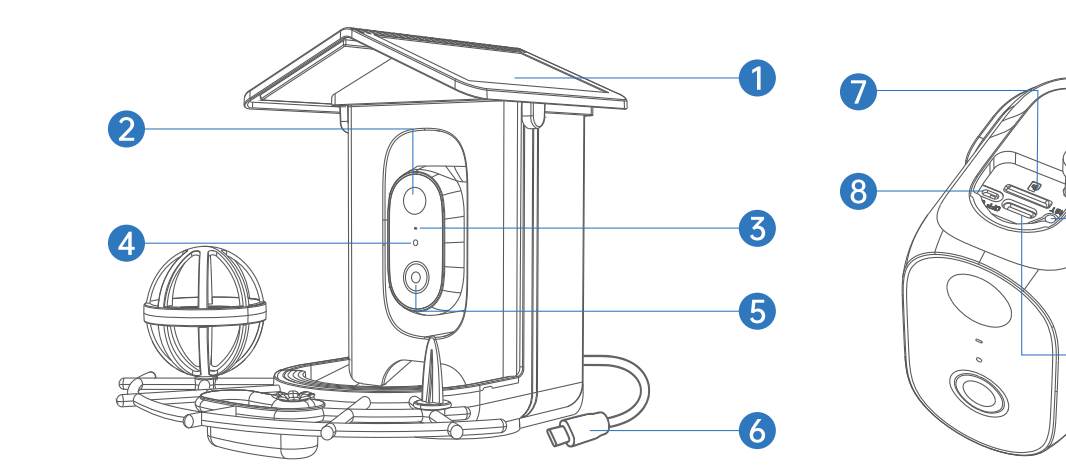

#### Bird Feeder

- Solar Panel
- PIR Sensor
- Microphone
- Light Sensor
- Lens
- Solar Panel Charging Cable

#### Camera

- MicroSD Card Slot
- Power Button
- Reset Button
- Type-C Port
- Silicone Cover

### Setup Instruction

#### 1. Fully charge the camera before use.

- The camera does not come fully charged due to safety regulations. Before using it for the first time, please charge it for 2-4 hours with the charging cable and power adapter inside the package.

#### 2. Download the App

- Scan the QR code below to download the [outinput] App with your phone.
- Open the App and follow the on-screen instructions to complete the account registration process.

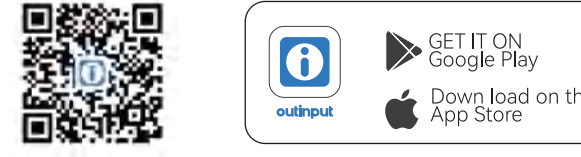

#### 3. Power On the Camera

- Open the silicone cover on the top of the camera, switch the power button to 'ON' to power on the camera.
- Wait until you hear beeping sound from the camera and Indicator light flashing.
- If you do not hear beeping sound, please make sure fully charged the camera, or long press the Reset button.

#### 4. Pair Camera with the App

- Open the App, click 'Add Device', click 'Bird Feeder PF710'.
- Follow the on-screen instructions to scan the QR code to add the camera.
- Only supports 2.4GHz Wi-Fi, make sure you're connected to a compatible network.
- Once connected, the flashing light will become solid, the repeating sound will stop, and you'll see the camera appear on the app's homepage.

#### 5. Connect Solar Panel

- Connect the charging cable on the back of the solar panel roof to the adapter cable on the back of the bird feeder.
- Cover the silicone mat on the top of the camera, plug the charging cable next to the camera into the Type-C power port on the top of the camera.
- After completing the above two steps, the solar panel power supply is ready.

#### 6. Assemble Roof/Perch/Containers

- Hold the back end of the solar panel roof and press it down along the hinge until you hear a clicking sound. This indicates the roof is securely installed.
- Align the three clips of the perch with the three holes at the bottom of the feeder, then press down firmly to complete the installation.

- Attach the hummingbird feeder and container, suet ball feeder, and the fork to their corresponding positions on the perch to complete the installation.

### Indicator Light

Status	Indicator Light
Power On	Green light flashes briefly, then blue light blinks slowly
Pairing	Blue light flashes slowly
QR Code Scanned	Green light flashes rapidly
Pairing Successful	Green light stays on
Camera Wake-up	Green light stays on
Charging	Red light stays on

### Outdoor Installation

#### A. Tree-mounted

- Thread the strap through the slot of the mounting bracket.
- Wrap the strap around the tree, pull it tight, and press it into the buckle to secure firmly.
- Place the feeder onto the mounting bracket and tighten the knob to lock it in place.

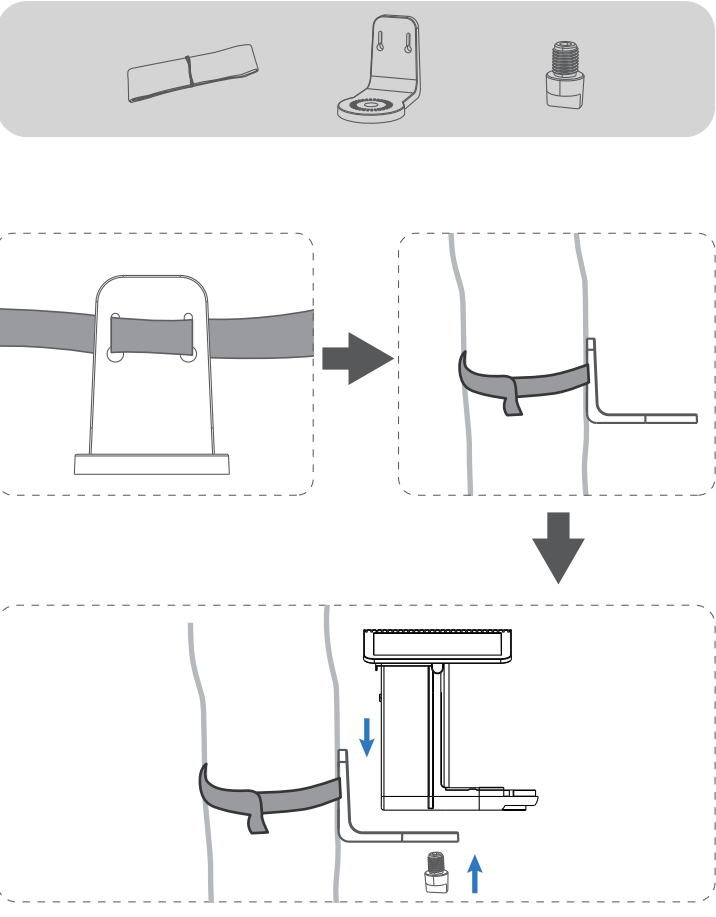

#### B. Wall-mounted

- Drill two holes in the wall using an electric drill.
- Insert the provided plastic expansion anchors into the holes (skip this step if mounting on wood), then hang the mounting bracket to the wall with screws.
- Place the feeder onto the mounting bracket and tighten the knob to lock it in place.

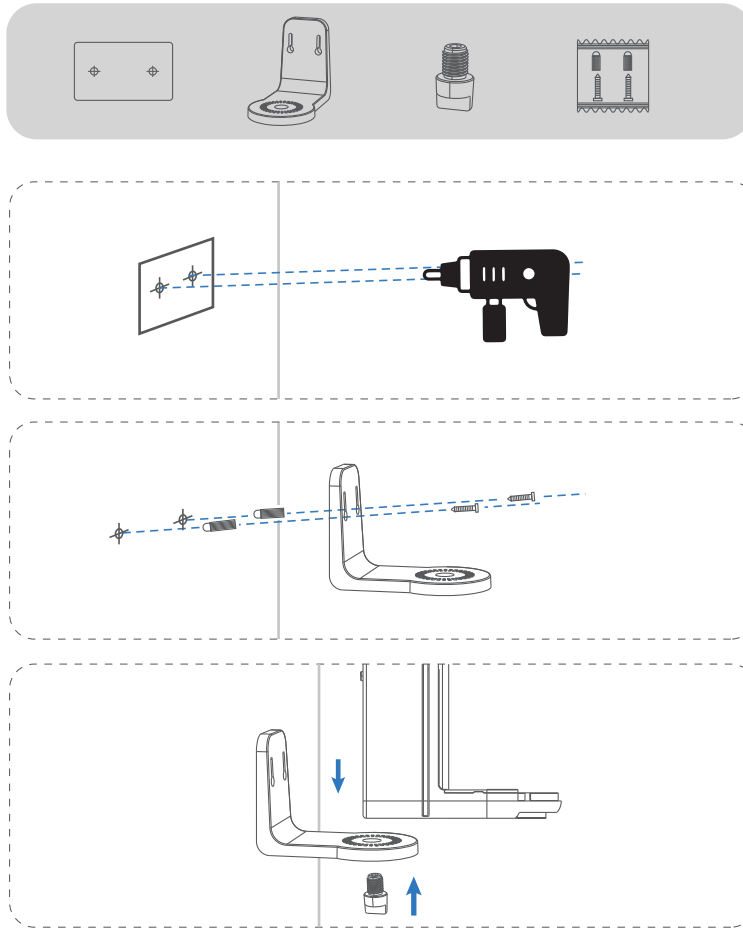

### Adding Bird Seed

Filling up the seed container is super easy! You can access the seed container from the rear of solar panel roof.

- Open the rear roof by pulling it up.
- Fill your own container with your bird food of choice.
- Pour the food into the seed contained through the rear roof opening and prevent the seed from spilling.
- Close the roof by pressing it down the feeder until you hear a clicking sound.

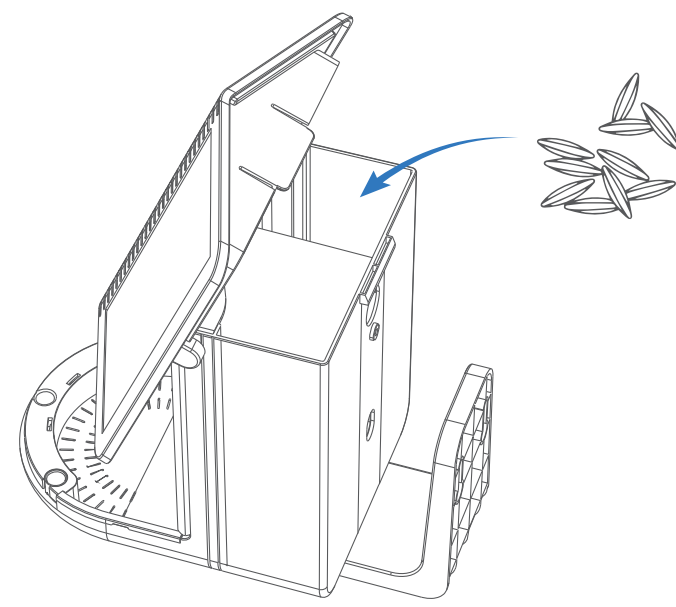

### App Function Instruction

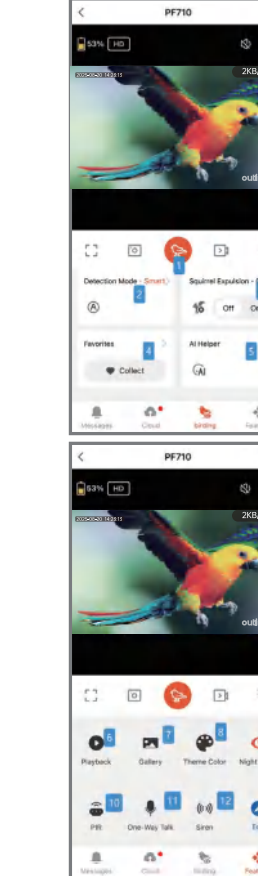

- Bird Recognition:** Automatically identifies birds in the live view.
- Detection Mode:** Pushes notifications only for birds and squirrels based on your settings.
- Squirrel Repellent:** Supports intelligent auto-repelling as well as manual on/off control of the alarm.
- Favorites:** Save special moments once the Smart Bird Recognition Cloud Storage feature is enabled.
- AI Helper:** Ask the AI assistant questions and get information about birds.
- Playback:** View previously recorded videos.
- Gallery:** Access saved screenshots and manually recorded videos.
- Theme Color:** Switch between light mode and dark mode.
- Night Vision Mode:** Choose between Smart Mode and Infrared Mode. Smart Mode automatically turns night vision on/off according to ambient light.
- PIR Sensor:** When enabled, the Passive Infrared sensor wakes the camera when people or animals pass by. Sensitivity can be set to Low/Medium/High or turned off as needed.
- One-Way Talk:** Supports one-way or two-way audio communication, adjustable in the basic function settings.
- Siren:** Activate the siren at any time when danger is detected to scare away potential threats.

### Frequently Asked Questions

#### 1. Camera turns on but no response?

- If there is no response from the camera after performing the startup action on top of the camera, i.e., the indicator light does not turn on or you do not hear the camera's connection prompt sound, you can try the following steps:
- Use the power adapter and charging cable included in the packaging to fully charge the camera for 2-4 hours.
- Restart the camera, locate the reset button on top of the camera, press it for 5-10 seconds until you hear the connection prompt sound or the power indicator light turns on, and enter the waiting-to-connect state.
- If there is still no response, please contact our support email for assistance.

#### 2. Can't pair the camera via Bluetooth?

- This product currently does not support Bluetooth pairing mode. You can manually select the Bird Feeder PF710 product icon and initiate the pairing process by scanning the pairing QR code on the app using the camera lens.

#### 3. Why can't find my Wi-Fi network while pairing?

- If the app can't find your Wi-Fi network at all, you might have an incompatible network. Please note the PF710 bird feeder camera only supports 2.4GHz Wi-Fi network, does not support 5GHz Wi-Fi network.

#### 4. What can I do if the camera keeps getting offline?

- Ensure the camera is connecting to 2.4GHz Wi-Fi signal.
- Ensure the camera is not too far away from the Wi-Fi router.
- Ensure your Wi-Fi router is working properly. Check the status of other devices such as laptop or smartphone and see if you can stream videos.
- The router may get overloaded sometime, try restarting your router and wait for 2-3 mins.
- Check if the camera is on latest firmware.

#### 5. How can I check if the solar roof is working?

- When the solar roof captures direct sunlight, you can see the small lightning bolt icon in your feeder battery's status on the lefttop in live stream page, which means the solar roof is working properly.
- Some regions enjoy consistent, strong sunshine while others encounter more intermittent sun exposure. For optimal solar charging, position the panel side of the roof away from shadows cast by trees or buildings during peak sunlight hours. However, factors like temperatures, particularly colder conditions, and heightened bird activity (leading to more photos being captured) can also impact battery consumption. All these factors combined mean that while the solar roof aids in significantly extending battery life, it may not sustain the bird feeder charge indefinitely in every scenario.

### Warranty

- Enjoy a 30-day return policy
- 12-month limited warranty for peace of mind
- Timely Customer service: support@out-input.com

### Specifications

Product Name: Smart Bird Feeder  
Resolution: 2.5K 4MP  
FOV: up to 147°  
Waterproof: IP65  
Power Consumption: 3W  
Power Input: Type-C 5V/1A  
Power Adapter: DC 5V  
Battery Capacity: 5200mAh  
Solar Charging Power: 3W  
Cloud Storage: Supported  
Local Storage: Supports MicroSD card (up to 256GB)  
Video Compression: H.264/H.265 high profile  
Image Enhancement: WDR, 3D noise reduction  
Wireless Encryption: WEP / WPA / WPA2  
Wireless Connection: 2.4G 802.11 b/g/n  
Wi-Fi Cover Range: 50-100M (Barrier-free)  
Network Configuration: QR Code  
Supported Platform: Android / iOS

### FCC Compliance Statement

- This device complies with Part 15 of the FCC Rules. Operation is subject to the following two conditions:
- (1) This device may not cause harmful interference.
- (2) This device must accept any interference received, including interference that may cause undesired operation.

Warning: Changes or modifications not expressly approved by the party responsible for compliance could void the user's authority to operate the equipment.

This symbol indicates that this product shall not be treated as household waste. Instead it shall be handed over to the applicable collection point for the recycling of electrical and electronic equipment.

### CE-RED

This product complies with the radio interference requirements of the European Community.

### Declaration of Conformity

HerebyThinkTech Innovation Inc declares that the device is in compliance with the essential requirements and other relevant provisions of Directive 2014/53/EU. For the declaration of conformity, visit the Web: <https://www.out-input.com>. This product can be used across EU member states. Due to the used enclosure material, the product shall only be connected to a USB interface of version 2.0 or higher. The adapter shall be installed near the equipment and shall be easily accessible. Do not use the device in the environment at too high or too low temperature, never expose the device under strong sunshine or too wet environment.

### RF Exposure Information

This Maximum Permissible Exposure (MPE) level has been calculated based on a distance of d=20cm between the device and the human body. To maintain compliance with RF exposure requirement, use product that maintain a 20cm distance between the device and human body. Restricted to indoor use.